

## Installation & Product Care Instructions

Please Retain these Instructions for Future Reference

### Installation

The size of the wall cabinet is 300mm(W) x 670mm(H) x 160mm(D).

It should be fixed through the 4 pre-drilled holes provided in the rear of the cabinet.

Position the cabinet in the desired location & mark through the fixing holes. Use a spirit level to ensure the cabinet is perfectly straight.

Drill holes in the marked positions using a suitable drill bit to a depth of 26mm.

Insert the wall plugs provided into the holes, reposition the cabinet and screw securely into place.

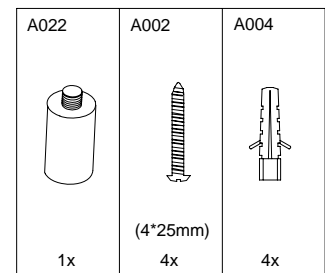
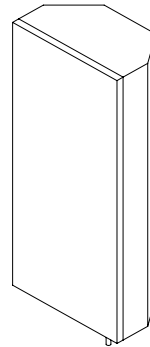

Note: Wall plugs & screws provided are only suitable for stone, brick or generally solid walls. For plasterboard, particleboard and hollow walls it will generally be necessary to use alternative specialist fixings available from all good DIY stores. Ensure the wall on which the cabinet is to be mounted is of sufficient strength. If in doubt seek specialist advice.

General Safety Note: Take care when using power tools in the bathroom. The use of an RCD (Residual Current Device) is recommended. Always wear eye protection when drilling. Beware of hidden cables or pipe runs.

### Product Cleaning

When cleaning glass and steel surfaces use a soft damp cloth with washing up liquid or similar. Do not use washing powders or any other substance containing abrasives since these substances will scratch glass. Do not use cleaners containing bleach, as this will effect the stainless steel surface.

### Warnings

1. Do not place very hot or very cold items against or in close proximity to glass surfaces unless adequately thick insulating material is used to prevent such items from coming into contact with the glass.
2. Do not strike the glass with hard or pointed items.
3. Please ensure cabinet is securely fixed to the wall using the guidelines already outlined above before it is used for the first time.
4. Installation must only be done by a qualified person.