

INSTALLATION INSTRUCTIONS

Cool extrafill bath filler & pop-up single ended bath chr - **40044440065**

Cool extrafill bath filler & pop-up double ended bath chr - **40044440070**

Important

- We recommend that this product is installed by a qualified professional contractor. Such as a plumber who is certified by NVQ (National Vocational Qualification) or SNVQ (Scottish National Vocational Qualification) Level 3.
- Please check this product immediately to ensure that it has not been damaged and is complete. Before installation, please make sure this product is the correct model and you have all the parts required for installation and using.
- Please read these instructions carefully and keep it for future reference.

Dimensions

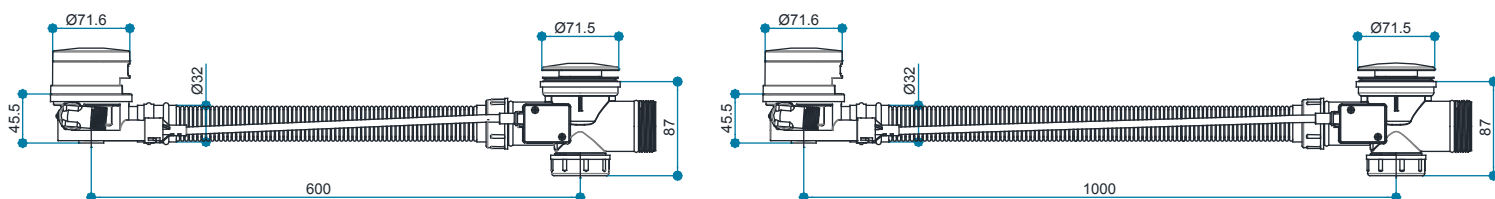

Installation

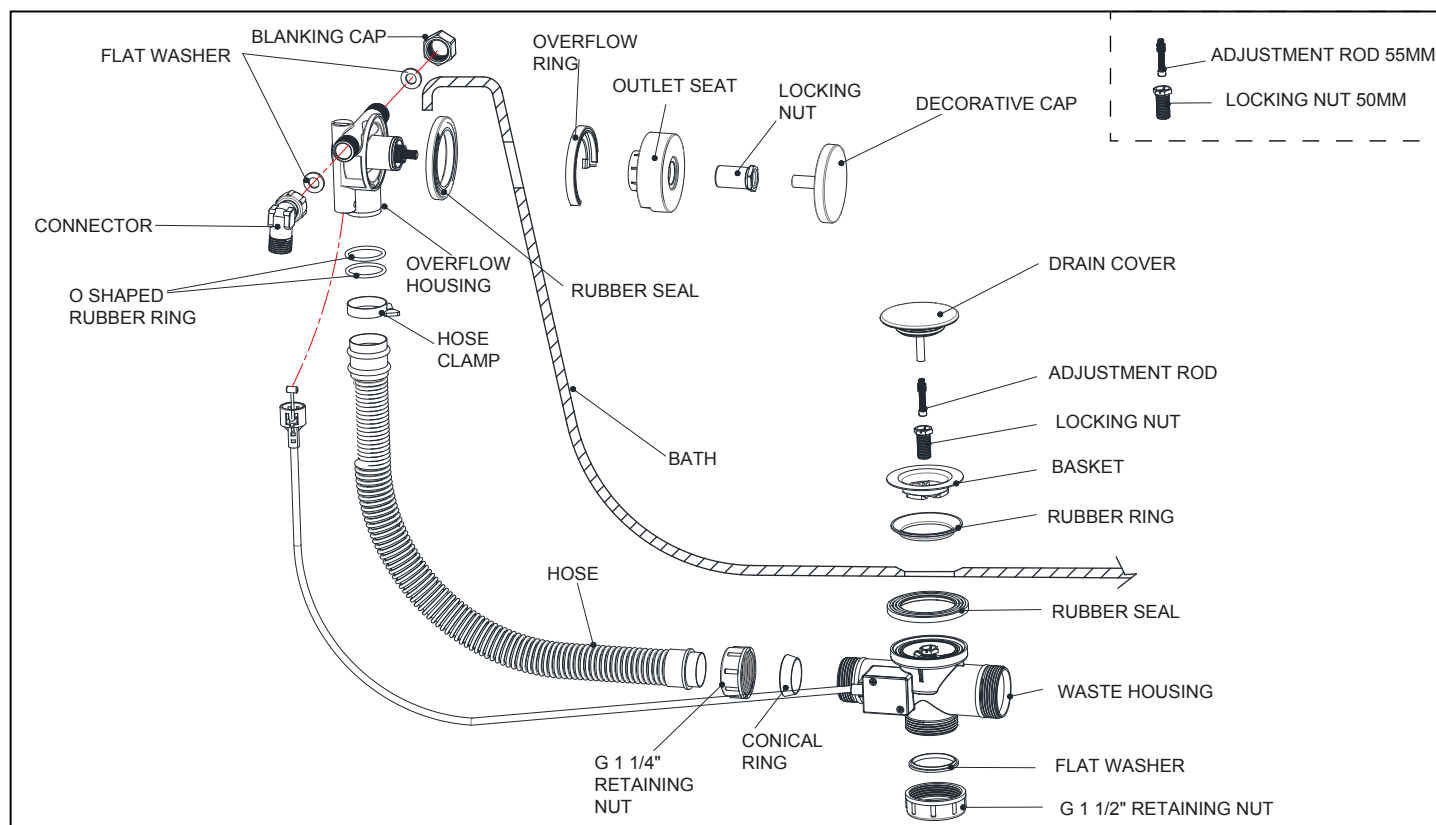

Installation

1. Fit the rubber seal into overflow housing, then hold this unit in position from the backside of the bath.
2. From inside of bath, place the overflow ring and outlet base over bath overflow hole and screw on the locking nut.
3. Screw the cover onto the locking nut.
4. Put the waste base and washer into the bottom waste hole of bath. Place the rubber washer and waste housing onto the waste from the backside of bath in sequence. Tighten all the above elements together.
5. Please note two connectors and one blanking cap are provided. They can be used depending on the onsite installation.

Maintenance

Clean with warm soapy water or a mild detergent. Do not use abrasive or chemical cleaners as these can damage the surfaces and material. Please see our website www.bathstore.com for any assistance.